



# KLINGER FLUID CONTROL

With passion  
for outstanding quality



# KLINGER GROUP

trusted.worldwide.

As one of the world's leading quality manufacturers and suppliers of seals and valves KLINGER runs production locations, distribution and service centres in over 40 countries. We boast a track record of over 125 years. Our flexibility, know-how and pioneering spirit let our Group self-confidently face any challenge of traditional and new

markets. The KLINGER brand is the epitome of technical reliability, power of innovation and highest quality. Products and processes accurately tailored to our customers' needs allow us to meet strictest requirements in an international market environment.

€ **410**  
**million**  
annual sales

In fiscal year 2014, the KLINGER Group generated sales of 410 million euros.



**2,300**  
employees

Our global workforce amounts to 2,300 persons worldwide



**80**  
destination countries of the Group's previous exports



**19**  
production locations worldwide



for seals, valves and instrumentation



**60**  
countries worldwide are home to a Group subsidiary or representative

# KLINGER FLUID CONTROL

Today for tomorrow

KLINGER Fluid Control is a subsidiary of the KLINGER Group. At our factory in Gumpoldskirchen, Austria, we have been developing, producing and updating industrial valves for over 125 years. Our global distribution network brings standardised and tailored products and services to our many customers.

Our products are noted for their high reliability, long life cycle and extremely low total cost of ownership. We focus on solutions which makes us a competent partner for many questions our customers may have and a provider of unique customer benefits by concentrating on our core competencies:

## COMPREHENSIVE CUSTOMER SERVICE

- » Product training
- » Application expertise
- » Rapid handling of offers and orders
- » Tailored logistical concepts
- » Valve updates
- » Spare parts supply
- » Technical support on site

## INNOVATIVE SOLUTIONS

- » Developing multi-variant standard products
- » Designing tailored solutions
- » Automation solutions
- » Many certificates & approvals
- » State-of-the-art development tools
- » Product tests at our own Technical Centre

## OPERATIONAL EXCELLENCE

- » Transparent supply chain
- » Flexible production
- » Short delivery times
- » Top quality (ISO 9001)
- » Best ecological practice (ISO 14001, EMAS)



# PRODUCT OVERVIEW

**Ballostar® KHI ball valves**  
» 06-07



**Monolith KHO ball valves**  
» 08-09



**Ballostar® KHE ball valves**  
» 14-15



**KVN piston valves**  
» 16-17



## APPLICATIONS



INDUSTRY



OIL & GAS



CHEMICAL



INFRASTRUCTURE



ENERGY



PHARMA





**Monoball® KHM ball valves**  
» 10-11

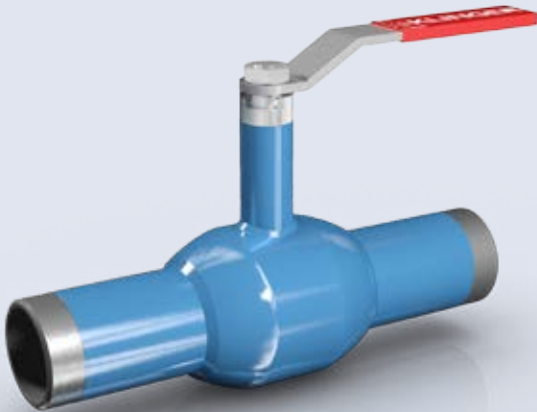

**Ballostar® KHA ball valves**  
» 12-13



**AB-cocks**  
» 18



**Gauge glasses**  
» 18

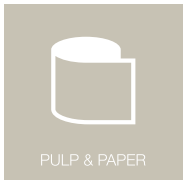

PULP & PAPER

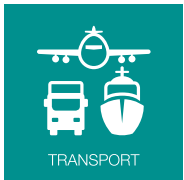

TRANSPORT

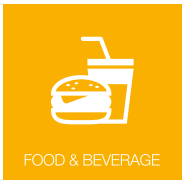

FOOD & BEVERAGE

# BALLOSTAR® KHI

Decades of reliability guaranteed

## BALLOSTAR® KHI

KLINGER Ballostar® KHI ball valves will keep up with stricter requirements and are assured to already meet future standards with regard to tensile, compressive and bending stress. Its unique sealing system is another feature of Ballostar® KHI. The test and drain valve welded to the ball valve housing allows the pressure to be relieved intermediately while the ball is closed. The key benefit of this feature is that Ballostar® KHI can be leak-tested at any time without having to open the pipeline. These ball valves are fit for many different applications such as underground district heating trenches, buried pipelines, co-generation power stations, pump stations, steelworks, hydroelectric power stations and tunnel boring machines.



## PRODUCT ADVANTAGES

- » Entirely maintenance-free
- » Supports pressurisation on either side
- » Trunnion-mounted ball with cylindrical full-passage duct
- » Bidirectional sealing to EN 12266 – leakage rate A
- » Sealing elements protected against surge pressure
- » Double block and bleed with intermediate venting (TÜV-certified)
- » Highly resistant to piping forces
- » Tested and certified to EN488:2015 (VVS)
- » Subsequent automation possible at any time (top flange to EN ISO 5211)

## SPECIAL TYPES

- » High-temperature version (up to +260°C)
- » Special design for tunnel boring machines
- » Preliminarily insulated design for buried installations (VVS)
- » Special ball coatings
- » Metal seat for abrasive operating media
- » Oxygen version (free from oil, grease and silicone)
- » Fire Safe design
- » Vacuum version
- » Gas version

## PRODUCT DETAILS

PN	16/25/40
DN	150 - 1000
Material	Cast steel, corrosion-proof and acid-proof cast steel, special materials upon request
Temperature	-45°C to +260°C
Design	Cones, flanges and welding ends, full and reduced bore, fully welded (VVS)
Type	Two-piece KHI ball valve, single-piece KHSVI VVS ball valve

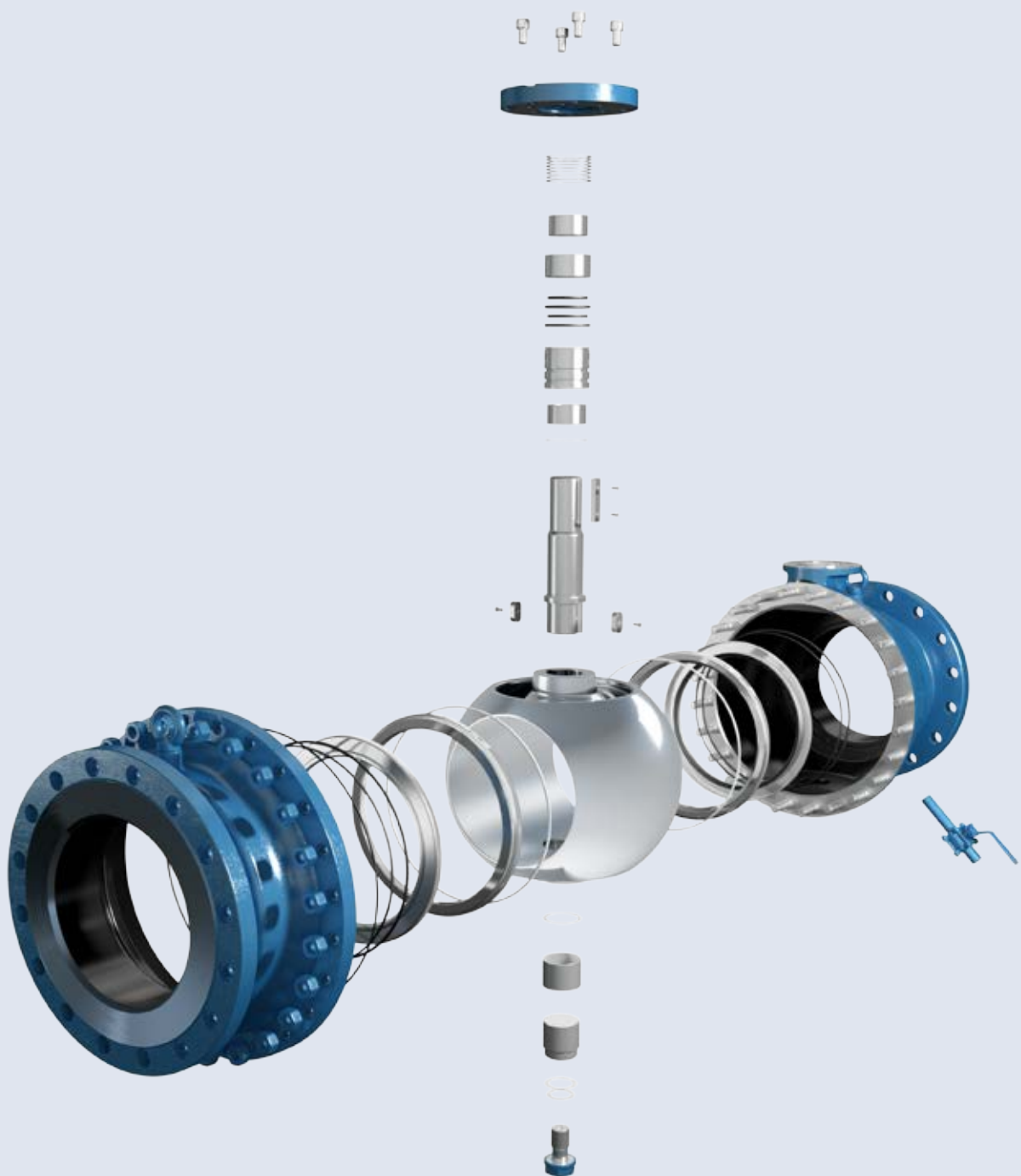

KHI » Screwed design with flanged ends

# MONOLITH KHO

Tough ball valve for harshest service conditions

## MONOLITH KHO

KLINGER Fluid Control teamed with Vienna Technical University to develop the housing of KLINGER's Monolith KHO and designed it to withstand the highest tensile and compressive forces as well as bending torques generated by pipelines. FEM calculations were applied to design and optimise the entire construction.



## PRODUCT ADVANTAGES

- » Entirely maintenance-free
- » Supports pressurisation on either side
- » Long heat-insulating shaft
- » Double-supported, blowout-proof operating stem
- » Multiple long-life stem seals
- » Highly resistant to piping forces
- » Tested and certified to EN488:2015
- » Meets the requirements of AFGW FW 401 – Part 5
- » Elastically pre-stressed sealing elements with stainless steel sine springs
- » Trunnion-mounted ball (DN200 or higher)
- » Stainless steel stem and shaft end

## SPECIAL TYPES

- » Pre-insulated version for plastic casing pipes
- » Different shaft lengths available
- » Automation-ready top flange to EN ISO 5211

## PRODUCT DETAILS

PN	25/40
DN	25 - 300
Material	Cast steel, special materials upon request
Temperature	-10 °C to +200 °C
Design	Welding ends for underfloor installation, reduced bore
Type	Single-piece ball valve





# MONOBALL® KHM

Versatile product for tailored solutions

## MONOBALL® KHM

KLINGER Monoball® KHM is a fully welded single-piece ball valve. The ball valves of this series have been uncompromisingly designed for their functionality in district heating, heating and air-conditioning systems or in general plant engineering. Apart from a wide range of standard versions, there are also various special Monoball® designs. They include a special version for buried applications for use in plastic casing pipe systems or buried draining and venting installations.

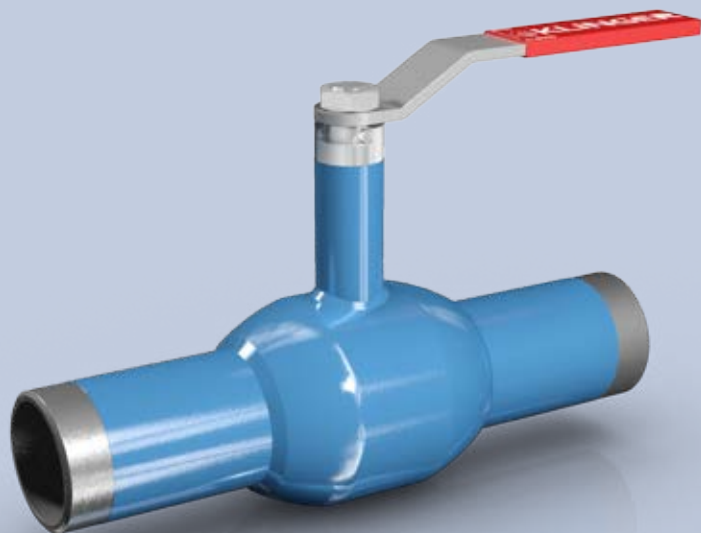

## PRODUCT ADVANTAGES

- » Entirely maintenance-free
- » Supports pressurisation on either side
- » Long heat-insulating shaft
- » Many fully interchangeable link-up versions
- » Multiple long-life stem seals
- » Double-supported, blowout-proof operating stem
- » Stainless steel stem prevents contact corrosion
- » Elastically pre-stressed sealing elements with stainless steel belleville springs
- » Tested and certified to EN488 and FW401 – Part 5
- » Automation-ready (DN100 or higher with full bore)

## SPECIAL TYPES

- » Pre-insulated version for plastic casing pipes
- » Pre-insulated draining and venting adapters made of stainless steel for plastic casing pipe systems
- » Twin set with wall bracket
- » Special lengths
- » Topping valves (matching Hütz und Baumgarten's topping device)
- » Branching ball valves

## PRODUCT DETAILS

PN	16/25/40
DN	10 - 300
Material	Carbon steel and stainless steel
Temperature	0 °C to +200 °C
Design	Welding ends, flanges, threaded connection, male thread and combinations, full and reduced bore, hand lever, hexagon socket, buried installations
Type	Single-piece ball valve



# BALLOSTAR® KHA

Kit for many applications

## BALLOSTAR® KHA

KLINGER Ballostar® KHA ball valves consist of a modular construction kit which results in a great multiplicity of versions. Different link-up options can be combined and several types of sealing elements and shaft seals installed to ensure that the Ballostar® KHA series ball valves are general-purpose devices for almost any application.



## PRODUCT ADVANTAGES

- » Entirely maintenance-free
- » Supports pressurisation on either side
- » Ball with a cylindrical full bore
- » Unique pre-stressed and elastic sealing system
- » Bidirectional sealing to EN 12266 – leakage rate A
- » Modular kit of system components
- » Serviceable while installed in the pipeline
- » Antistatic design to ISO 7121 / EN 1983
- » Subsequent automation possible at any time (top flange to EN ISO 5211)

## SPECIAL TYPES

- » Metal seat (up to +400°C) for abrasive operating media
- » Shaft sealed by O-rings
- » Shaft extension
- » Oxygen version (free from oil, grease and silicone)
- » Cryogenic version down to -196°C
- » Fire Safe version
- » Vacuum version
- » Gas version

## PRODUCT DETAILS

PN	16/25/40/63/100
DN	10 - 125
Material	Cast steel, corrosion-proof and acid-proof cast steel, cast iron, nodular cast iron, special materials upon request
Temperature	-196 °C to +400 °C
Design	Flanges (long, short), threaded connections, welding ends (long, short), full and reduced bore
Type	Three-part ball valve



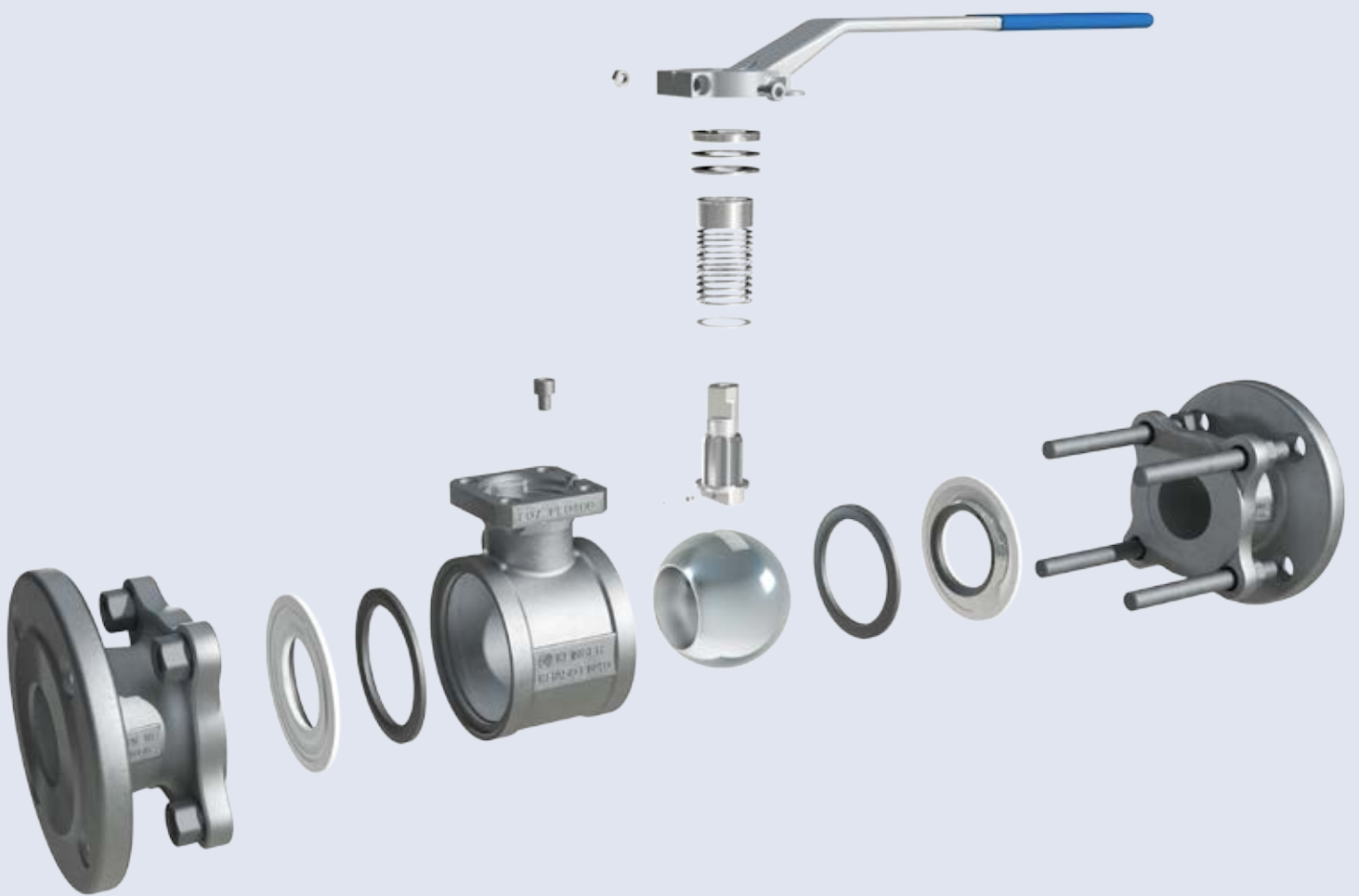

# BALLOSTAR® KHE

Compact valve for universal use

## BALLOSTAR® KHE

Owing to its different housing and sealing materials, KLINGER Ballostar® KHE can be used in a great many different applications. Thus, choosing the right modular system components yields a solution that accurately meets your requirements. Many different approvals warrant a high level of operational safety. Our ball valve series made to ASME standards would not be complete without a wide range of rated DIN widths of flange fittings.



## PRODUCT ADVANTAGES

- » Entirely maintenance-free
- » Supports pressurisation on either side
- » Ball with a cylindrical full bore
- » Bidirectional sealing to EN 12266 – leakage rate A
- » Modular kit of system components
- » Antistatic design to ISO 7121 / EN 1983
- » Fire Safe version
- » Subsequent automation possible at any time (top flange to EN ISO 5211)

## SPECIAL TYPES

- » Metal seat for abrasive operating media
- » Shaft sealed by O-rings
- » Shaft extension
- » Oxygen version (free from oil, grease and silicone)
- » Gas version

## PRODUCT DETAILS

PN	16/40, Class 150/300
DN	15 - 200, ½" - 8"
Material	Cast steel, corrosion-proof and acid-proof cast steel, special materials upon request
Temperature	-60 °C to +300 °C
Design	Flanges (long, short), full bore
Type	Two-part ball valve

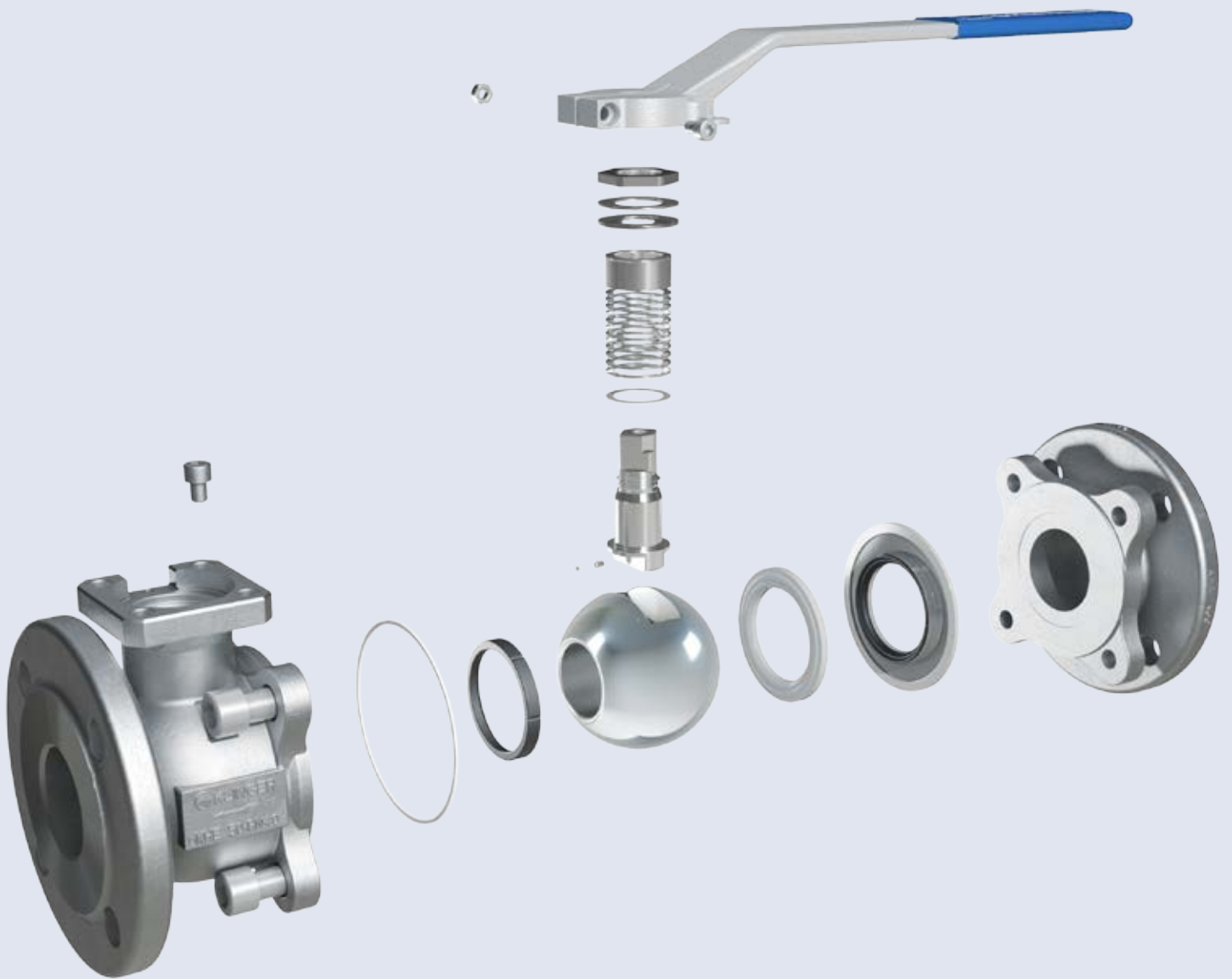

# KVN PISTON VALVE

The endlessly tried and tested original

## >> KVN

Due to constant technical product improvement, KLINGER has been and remains to be one of the leading manufacturers of piston valves. Different types of connections as well as DIN and ASME-compliant designs ideally supplement KLINGER's wide range of industrial valves.



## >> PRODUCT ADVANTAGES

- » Maintenance while installed in the pipeline
- » Leak-tightness to EN 12266 – leakage rate A
- » Excellent regulation
- » Suitable for alternate steam/condensate operation as well as for thermal shock operations
- » Special sealing elements for highest operation cycles
- » Insensitive to contaminated media
- » Fire Safe version
- » Automation-ready

## >> SPECIAL TYPES

- » Oxygen version (free from oil, grease and silicone)
- » End position detection (mechanical and inductive)
- » Adjustable version
- » Heating jacket

## >> PRODUCT DETAILS

PN	16/40/63, Class 150/300
DN	15 - 200, ½" - 8"
Material	Cast steel, corrosion-proof and acid-proof cast steel, cast iron, nodular cast iron, special materials upon request
Temperature	-10 °C to +400 °C (low-temperature models upon request)
Design	Flanges, threaded connection, socket weld-ends, butt weldends adjustment function
Type	Piston valve





# >> BOROSILICATE GAUGE GLASSES

The quality of a gauge glass mainly depends on its chemical composition and the mechanical strength of the glass material.

Analysing the glass by taking acid and base samples assures a uniform quality of the gauge glasses. Their mechanical strength is provided by heat-strengthening.



Transparent, reflex and circular gauge glasses

# >> AB-COCKS

AB-cocks are simple and extremely sturdy shut-off valves designed with the very specific needs of measuring technology in mind. Their unfailing operation and economic efficiency have earned them millions of practical applications worldwide.



# >> APPLICATIONS

- » Refineries
- » Petrochemistry
- » Pharmaceutical industry
- » Chemical engineering
- » Mechanical engineering, particularly boiler and vessel engineering
- » Foodstuffs and beverages industry
- » Water supply and distribution
- » Paper and pulp production
- » Textile industry
- » Maritime industry

# >> PRODUCT DETAILS

Design	Reflex gauge glass, transparent gauge glass, circular gauge glass
Material	"Extra strong" borosilicate
Temperature	-273 °C to +400 °C
Mica	For transparent gauge glasses
Spare parts sets	Available with KLINGER Sil seals

# >> PRODUCT ADVANTAGES

- » A generously sized sealing face ensures that the bore is reliably sealed and that measuring errors on the outside are prevented
- » Manual operation supported in throttle position
- » Simple design (just one moving part) for high-level operational safety
- » The sealing bush - the valve's only wearing part - can be replaced within a few minutes without having to remove the AB cock from the pipeline.
- » Special designs are available for pressure gauges, indicators and liquid level gauges

# >> PRODUCT DETAILS

PN	40/160/250
Design	ABM, MABA, ABI, ABZ etc.
Material	Brass, steel and stainless steel
Temperature	-200 °C to +400 °C
Variants	Various link-up types: Ermeto, Maihak, Burmeister, etc. Sealing bushes available in PTFE, KAF, KOR-AF

# GLOBAL NETWORK OF PARTNERS

Our know-how near you

## EUROPE

Belgium  
**KLINGER Sogefiltres**

Bulgaria  
**Polymat**

Denmark  
**KLINGER Danmark A/S**

Germany  
**KLINGER Fluid Control**

Germany  
**KLINGER Schöneberg**

England  
**Wika Instruments**

England  
**Trouvay & Cauvin Ltd**

Finland  
**KLINGER Aseko**

France  
**KF Fluid**

Greece  
**Chryssafidis S.A.**

Iceland  
**EP Verk**

Italy  
**KLINGER Italy s.r.l.**

Croatia  
**Tehnotrade D.O.O.**

Netherlands  
**KLINGER BV**

Norway  
**Bagges AS**

Austria  
**KLINGER Gebetsroither**

Poland  
**KLINGER w Polsce Sp.z.o.o.**

Portugal  
**KLINGER Portugal Lda.**

Romania  
**Rom Energy Armstrong**

Russia  
**KLINGER Rep. Moskau**

Sweden  
**Ventim & Instrument AB**

Switzerland  
**Franz Gysi AG**

Serbia  
**Ninacom D.O.O.**

Slovakia  
**S Armat**

Slovenia  
**Trimad D.O.O.**

Spain  
**Saidi**

Czech Republic  
**Ruml spol s.r.o**

Ukraine  
**Emerald-Technique LCC**

Hungary  
**Soltész + Soltész**

## AFRICA

Egypt  
**Nesco**

Ivory Coast  
**Trouvay-Cauvin Afrique**

Israel  
**Transtecnica Fluid Control**

Turkey  
**Isik**

VAE  
**Ados**

## ASIA

China  
**Sunitex**

China  
**KLINGER Shanghai**

India  
**Glasstech**

India  
**H.R.S.**

India  
**Uni KLINGER**

Indonesia  
**Trimitra Wisesa Abadi**

Iran  
**Klingeran**

Japan  
**Bunkaboeki Kogyo**

Japan  
**Miura**

Kazakhstan  
**Silumin Vostok**

Malaysia  
**Pacline**

Pakistan  
**Adenwalla & Sons**

Pakistan  
**Industrial Equipment**

Pakistan  
**Nova Engineering**

Philippines  
**Mheco**

Singapore  
**Gumpold Fluid Controls**

Sri Lanka  
**Ruby**

South Korea  
**Samkyong**

South Korea  
**Specs Corporation**

Taiwan  
**Sunny Brico**

Thailand  
**Alpha Group**

Vietnam  
**Southern Technology**

## AUSTRALIA

Australia  
**KLINGER Ltd.**

## NORTH AMERICA

Canada  
**A-Chem Group**

USA  
**Thermoseal**

## SOUTH AMERICA

Argentina  
**Rich. KLINGER S.A.A.C.I. y F**

Brazil  
**Richard KLINGER**



---

KLINGER Fluid Control GmbH  
Am Kanal 8-10 » 2352 Gumpoldskirchen » Austria  
Tel: +43 2252 600-0 » Fax: +43 2252 600-100  
office@klinger.kfc.at

[www.klinger.kfc.at](http://www.klinger.kfc.at)